

# Contents

---

<b>FRAME POSITIONING</b>	<b>F</b>
TRAVELLING Folding	F.10.E
<b>CROP PROCESSING</b>	<b>K</b>
CUTTING Gripping	K.10.D
GUIDING Crop guiding	K.12.B
FEEDING Header feeding	K.25.D
FEEDING Row unit	K.25.O
RESIDUE HANDLING Stalk chopper	K.64.B





**NEW HOLLAND**

## **FRAME POSITIONING - F**

**TRAVELLING Folding - 10.E**

**99C06R  
99C08F  
99C08R**

# Contents

---

## FRAME POSITIONING - F

### TRAVELLING Folding - 10.E

#### FUNCTIONAL DATA

##### TRAVELLING Folding

Hydraulic schema 3  
99C08F

##### Cylinder

Lock - Sectional view 4  
99C08F

Open/close - Sectional view 5  
99C08F

#### SERVICE

##### Cylinder

Open/close - Disassemble 6  
99C08F

Lock - Remove 8  
99C08F

Lock - Install 9  
99C08F

Lock - Disassemble 10  
99C08F

Lock - Assemble 12  
99C08F

## TRAVELLING Folding - Hydraulic schema

99C08F

**Only valid for 8-row Flip-up headers.**

- |  |                                 |
|--|---------------------------------|
| 1 Left-hand side header open/close cylinder  | 5 Left-hand side lock cylinder  |
| 2 Right-hand side header open/close cylinder | 6 Right-hand side lock cylinder |
| 3 Restrictor                                 | 7 Quick release couplers        |
| 4 -  |                                 |

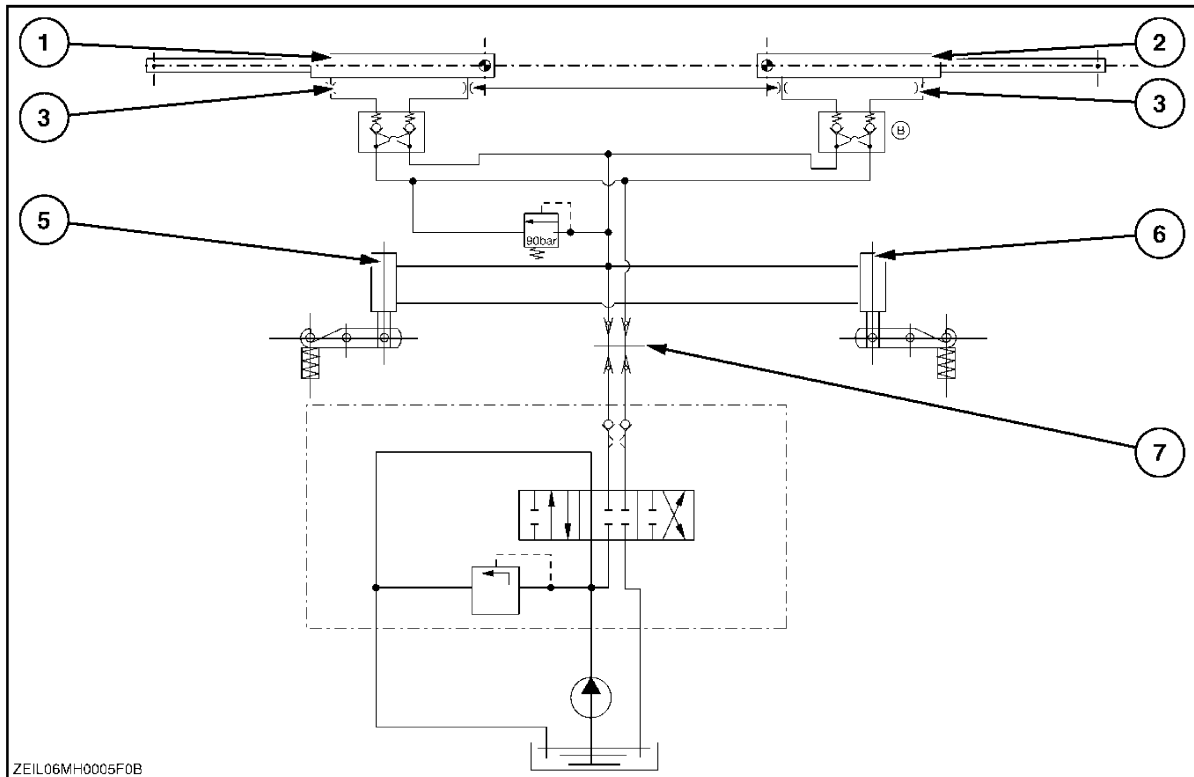

ZEIL06MH0005F0B 1

## Cylinder Lock - Sectional view

99C08F

Only valid for Flip-up headers.

- |                  |               |
|------------------|---------------|
| 1 Rod            | 8 Seal holder |
| 2 Wiper          | 9 Housing     |
| 3 O-ring         | 10 Piston     |
| 4 Rod seal       | 11 Lock nut   |
| 5 Piston seal    | 12 Nut        |
| 6 O-ring         | 13 Bushing    |
| 7 Retaining ring |               |

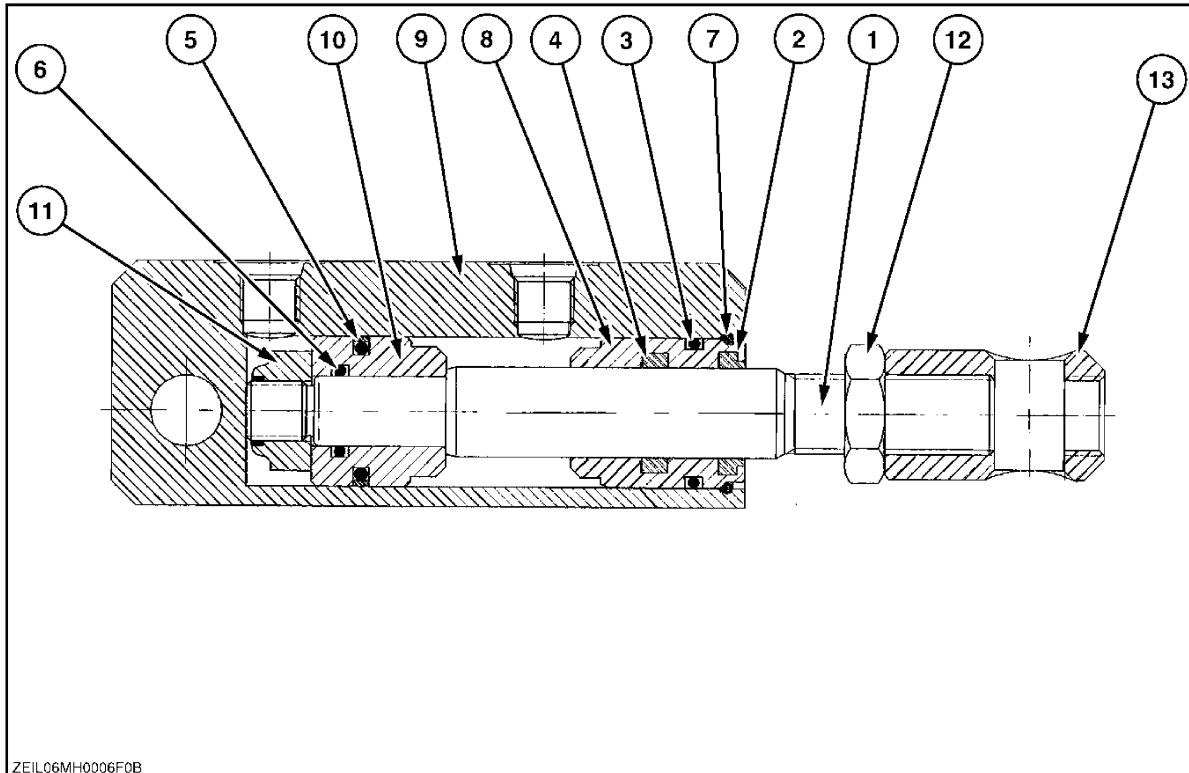

ZEIL06MH0006F0B

ZEIL06MH0006F0B 1

## Cylinder Open/close - Sectional view

99C08F

Only valid for Flip-up headers.

- |                    |                |
|--------------------|----------------|
| 1 Cylinder housing | 6 Scraper ring |
| 2 Guide bushing    | 7 Seal ring    |
| 3 Rod              | 8 Guide strip  |
| 4 Piston           | 9 Seal kit     |
| 5 Bushing          | 10 Plug        |

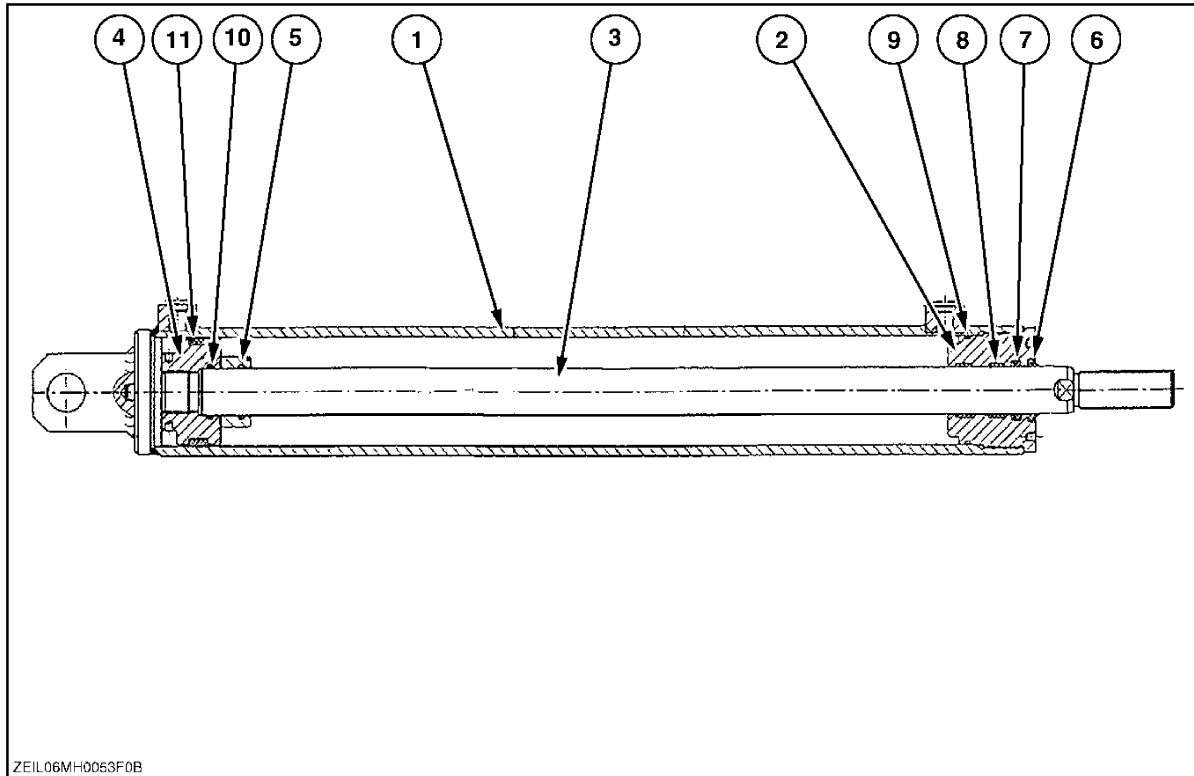

ZEIL06MH0053F0B

ZEIL06MH0053F0B 1

## Cylinder Open/close - Disassemble

99C08F

All seals can be replaced and are made available in a seal kit.  
Make sure to order the correct seal kit.

"Cylinder with a detachable cylinder head"

Proceed as follows:

1. Loosen the cylinder head **(1)** by turning the head clock wise, using a punch mark and a hammer.

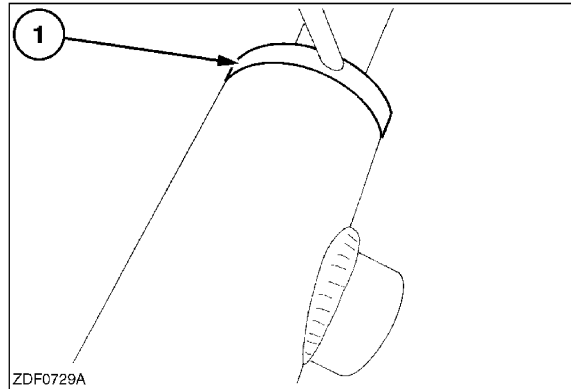

ZDF0729A 1

2. Pull out the piston rod **(2)**.

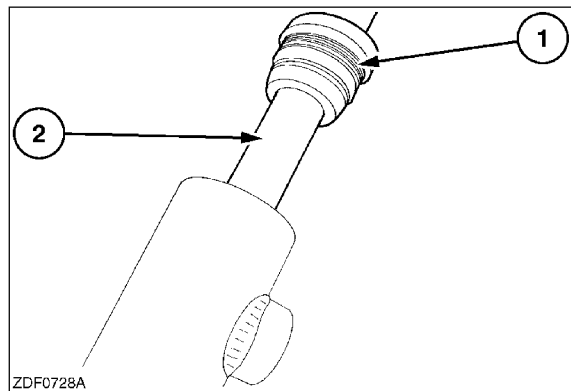

ZDF0728A 2

3. Remove the bolt **(3)** and the cylinder sleeve **(4)**.  
Now is it possible to remove the cylinder head **(1)** from the piston rod **(2)**.  
Remove all the seals.

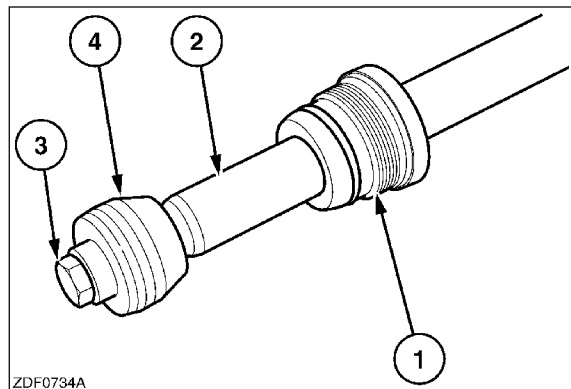

ZDF0734A 3



## FRAME POSITIONING - TRAVELLING Folding

4. Clean and oil the piston rod (2), the cylinder sleeve (4) and the seals and reassemble them. Slide the cylinder head (1) onto the piston rod (2). Install the cylinder sleeve (4) and tighten the bolt (3).

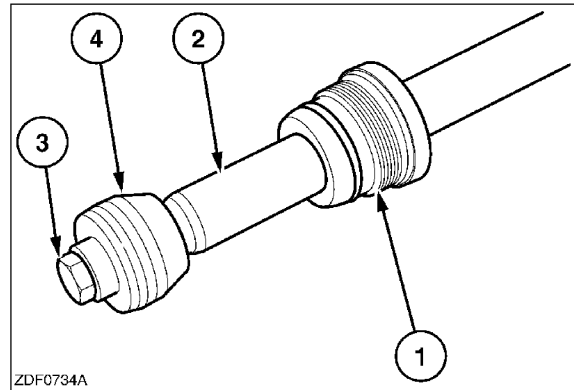

ZDF0734A 4

5. Slide the pre-assembled piston rod (2) in the cylinder housing. Turn the cylinder head (1) counter-clockwise onto the cylinder housing.

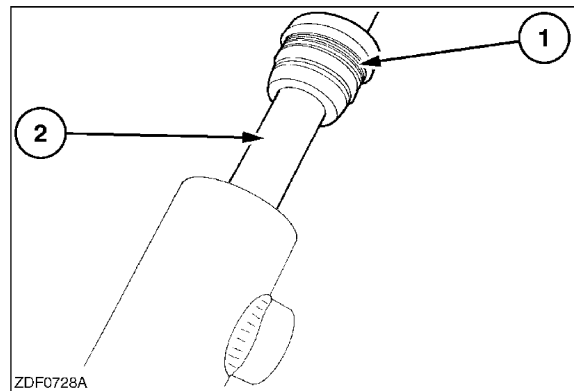

ZDF0728A\_72 5

6. Tighten the cylinder head, using a punch mark and a hammer.

---

## Cylinder Lock - Remove

99C08F



### CAUTION



Always raise the feeder all the way up and set the lift cylinder safety stand before working under the feeder or header. M421

---

### Only valid for flip-up headers.

1. Loose the fittings, making sure the system is pressurized.
2. Remove the cotter pin (18), the washer (17). Remove the pin (20). On the other side, remove the retaining ring (15) and the washer (14). Remove the pin (19) with the cylinder (16).

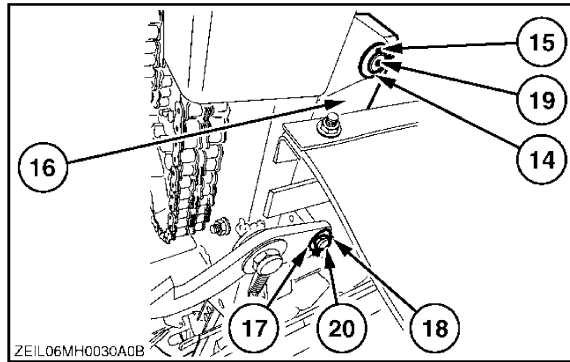

ZEIL06MH0030A0B 1

---

## Cylinder Lock - Install

99C08F



### CAUTION



Always raise the feeder all the way up and set the lift cylinder safety stand before working under the feeder or header. M421

---

### Only valid for flip-up headers.

1. Install the pin (19) through the cylinder housing (16) on the header. Install the washer (14) and the retaining ring (15).
2. On the other side, install the pin (20) through the cylinder bushing on the lock hook. Install the washer (17) and the cotter pin (18).

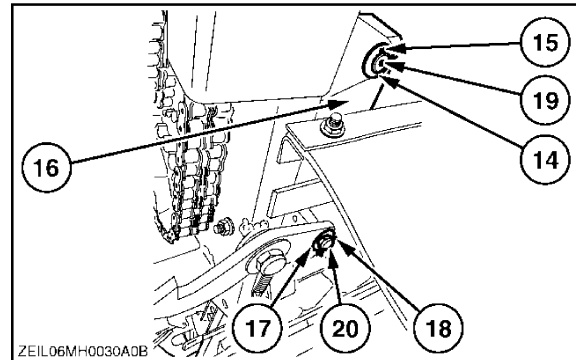

ZEIL06MH0030A0B 1

3. Connect the two fittings.

## Cylinder Lock - Disassemble

99C08F

### Prior operation:

### Cylinder Lock - Remove (F.10.E)

**NOTE:** For more information, refer to **Cylinder Lock - Sectional view (F.10.E)**.

### Only valid for flip-up headers.

1. Place the cylinder on the bench and remove the fittings. Drain residual oil from the cylinder.
2. Push in the seal holder (8) to gain access to retaining ring (7).

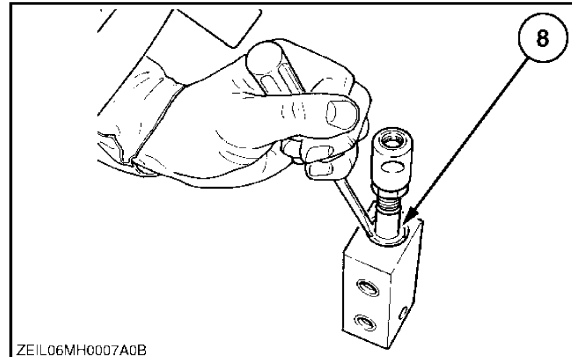

ZEIL06MH0007A0B 1

3. Remove the retaining ring (7) from the cylinder housing. Withdraw the rod (1) completely with the seal holder (8) and the piston (10) from the cylinder housing (9).

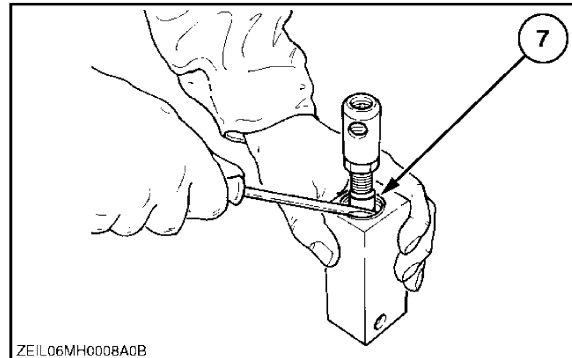

ZEIL06MH0008A0B 2

4. Renew the O-ring (3) and the seal (5) if necessary.

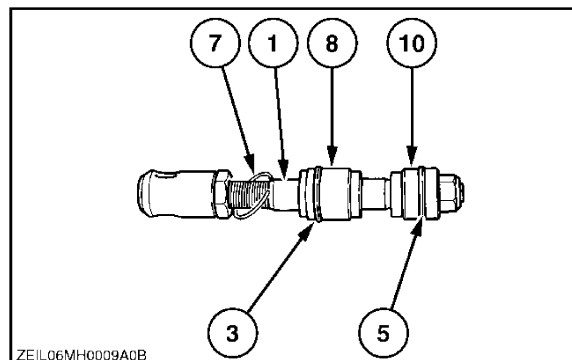

ZEIL06MH0009A0B 3

## FRAME POSITIONING - TRAVELLING Folding

5. To disassembly the rod assembly, remove the lock nut (11).

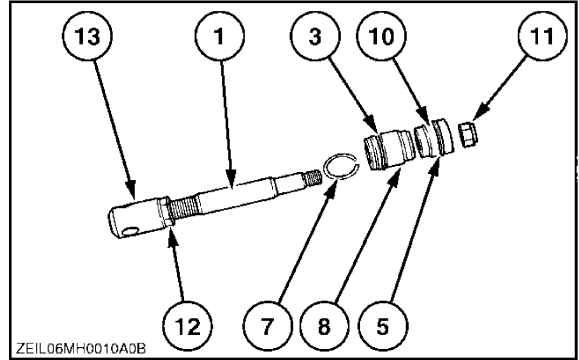

ZEIL06MH0010A0B 4

6. Once the seal holder (8) is removed from the rod (1), the wiper (2) and the rod seal (4) can be renewed. If necessary, renew the O-ring (6) from the piston (10).

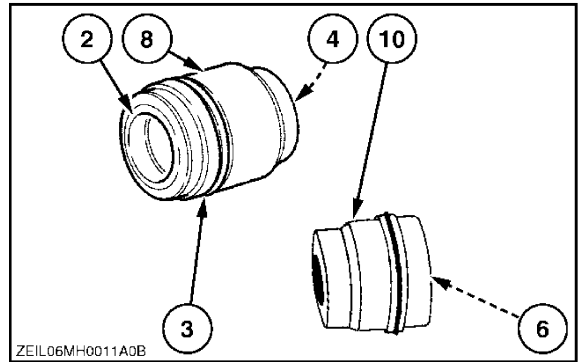

ZEIL06MH0011A0B 5

## Cylinder Lock - Assemble

99C08F

**NOTE:** For more information, refer to *Cylinder Lock - Sectional view (F.10.E)*.

### Only valid for flip-headers.

1. Reassemble the seal holder (8) with the wiper (2), the rod seal (4) and the O-ring (3).  
Reassemble the piston (10) with the O-ring (6) and the piston seal (5).

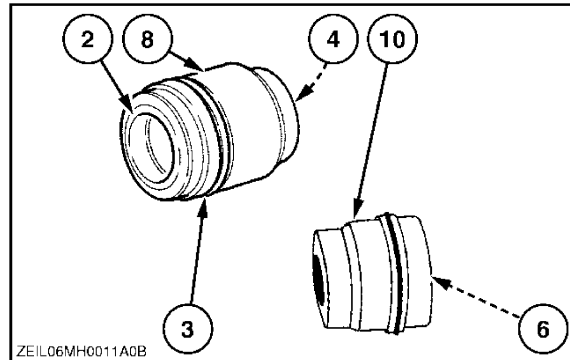

2. Install both assemblies, the seal holder and the piston on the rod (1) and fix with the lock nut (11) at a torque between **40 - 60 Nm (29 - 44 lb ft)**.

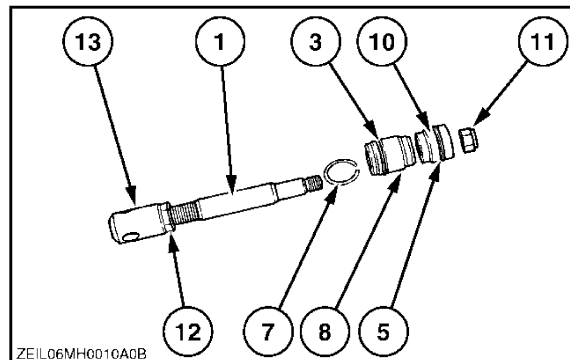

3. Insert the whole assembly in the cylinder housing (9). Drive the seal holder (8) into the housing (9) and install the retaining ring (7). Withdraw the rod (1) to insure the correct position of the seal holder (8).

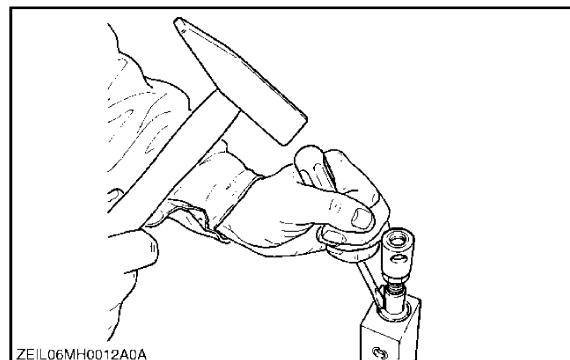

4. Reinstall the fittings on the cylinder housing.

**Next operation:**  
**Cylinder Lock - Install (F.10.E)**

# Index

---

## FRAME POSITIONING - F

### TRAVELLING Folding - 10.E

Cylinder Lock - Assemble 99C08F	12
Cylinder Lock - Disassemble 99C08F	10
Cylinder Lock - Install 99C08F	9
Cylinder Lock - Remove 99C08F	8
Cylinder Lock - Sectional view 99C08F	4
Cylinder Open/close - Disassemble 99C08F	6
Cylinder Open/close - Sectional view 99C08F	5
TRAVELLING Folding - Hydraulic schema 99C08F	3





# Contents

---

## CROP PROCESSING - K

<b>CUTTING</b> Gripping 99C06R , 99C08F , 99C08R	K.10.D
<b>GUIDING</b> Crop guiding 99C06R , 99C08F , 99C08R	K.12.B
<b>FEEDING</b> Header feeding 99C06R , 99C08F , 99C08R	K.25.D
<b>FEEDING</b> Row unit 99C06R , 99C08F , 99C08R	K.25.O
<b>RESIDUE HANDLING</b> Stalk chopper 99C06R , 99C08F , 99C08R	K.64.B





**NEW HOLLAND**

## **CROP PROCESSING - K**

### **CUTTING Gripping - 10.D**

**99C06R  
99C08F  
99C08R**

**Thanks very much for your reading,  
Want to get more information,  
Please click here, Then get the complete  
manual**

**JustClickHere** 

**NOTE:**

**If there is no response to click on the link above,  
please download the PDF document first, and then  
click on it.**

**Have any questions please write to me:  
[admin@servicemanualperfect.com](mailto:admin@servicemanualperfect.com)**